

VIOLA PARK KITCHEN SYSTEM COMPONENTS

This is a general overview. Please see the pricelist for a complete listing of the available components.

Standard width increments for base, wall and pantry units:
12", 15", 18", 21", 24", 27", 30", 32", 36", 42"

Select horizontal wall units are also available in:
48", 60", 72", 84"

COMPONENT

DESCRIPTION

AVAILABLE MATERIALS/FINISHES

DOORS

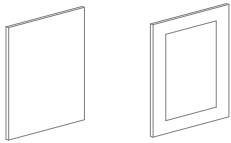

Flat Front door Frame & Panel door

Flat Front and Frame & Panel doors are available

Flat Front Doors: pigmented lacquer, walnut, grey oak

Frame & Panel Doors: walnut, grey oak

BASE UNITS: 30" TALL 2 DEPTHS: 24 5/8", 18"

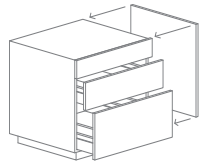

Base unit with drawers

Base Units With Drawers
2 drawer base
3 drawer base
4 drawer base

Base Cabinet Bodies: laminate on 3/4" plywood - 3/4" backs on all cabinets

Flat Front Doors and Drawer Fronts: pigmented lacquer, walnut, grey oak

Frame & Panel Doors and Drawer Fronts: walnut, grey oak

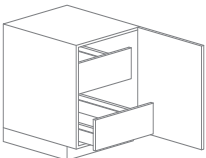

Base unit with doors

Base Units With Doors*
Leaf door base with 1 interior drawers
Leaf door base with 2 interior drawers
Leaf door base with 3 interior drawers
Leaf door base with adjustable shelves inside (not shown)
* Units wider than 27" have two doors
* Units wider than 32" have interior vertical divider

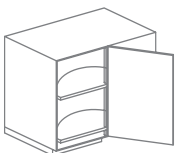

Corner unit

Corner Unit
Corner unit with rotating storage access - 18", 21" wide

COMPONENT

DESCRIPTION

AVAILABLE MATERIALS / FINISHES

SPECIAL PURPOSE BASE UNITS

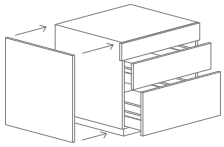

End unit left

End of Run Unit- used to finish the end of a run, includes end panel

Base Cabinet Bodies: laminate on 3/4" plywood - 3/4" backs on all cabinets

Flat Front Doors and Drawer Fronts: pigmented lacquer, walnut, grey oak

Frame & Panel Doors and Drawer Fronts: walnut, grey oak

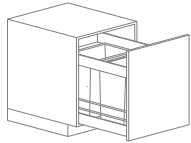

Trash unit

Single Trash Unit - (1) 40 L bin (not shown)
Double Trash Unit - (2) 35 L bins
*Optional interior drawer

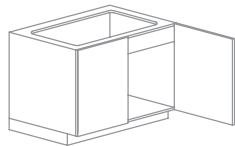

Sink unit with doors

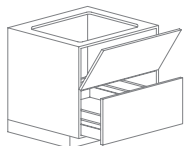

Sink unit with flip

Sink unit with 1 doors (not shown)
Sink unit with 2 doors
Sink unit with 1 drawer and flip down above
Optional: interior drawer
Note: units wider than 27" have 2 doors

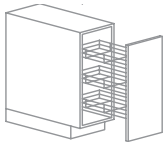

Pantry unit

Pantry Pullout Unit

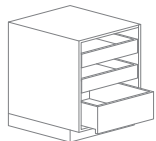

Open accent unit

Open Accent Unit with wood drawers - 2 depths: 18", 24"

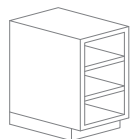

Bookshelf unit

Bookshelf Unit depths: 12 7/8"

COMPONENT

DESCRIPTION

AVAILABLE MATERIALS / FINISHES

SPECIAL PURPOSE BASE UNITS CONTINUED

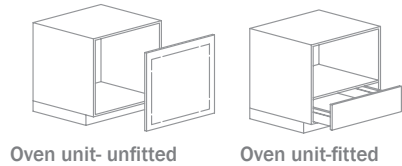

Appliance Units
 Oven Unit- unfitted and fitted for select models
 Cooktop Unit with 2 drawers (not shown)
 Cooktop Unit with leaf doors (not shown)
 Undercounter Microwave Unit (not shown)

Base Cabinet Bodies: laminate on 3/4" plywood - 3/4" backs on all cabinets

Flat Front Doors and Drawer Fronts: pigmented lacquer, walnut, grey oak

Dishwasher Front Panels*
 Front Panel for 24" European dishwasher
 Front Panel for 24" US dishwasher
 Front Panel for 18" Miele dishwasher
 * See panel section

Frame & Panel Doors and Drawer Fronts: walnut, grey oak

HORIZONTAL WALL UNITS: 14 7/8" DEEP



Horizontal Wall Units - 16", 22" tall
 Flip-up Door
 Leaf Doors*
 Glass Sliding Doors
 Open Unit (not shown)
 Concealed Hood Vent Unit (not shown)
 *Units wider than 21" have 2 doors

Cabinet Bodies: veneer - walnut, grey oak

Flat Front Doors: pigmented lacquer, walnut, grey oak

Frame & Panel Doors: walnut, grey oak

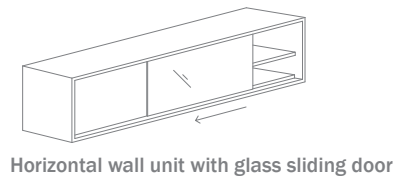
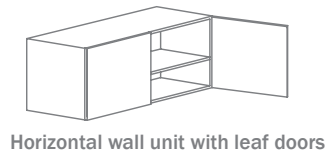

COMPONENT

DESCRIPTION

AVAILABLE MATERIALS / FINISHES

MEDIUM AND TALL WALL UNITS

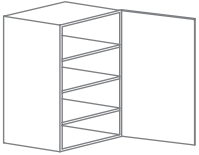

Medium height vertical unit

Medium Height Vertical Units -
24" Tall
14 7/8" Deep
Leaf Door(s)*
Open Unit with adjustable shelves
Concealed Hood Vent Unit
*** Units wider than 24" have two doors**

Cabinet Bodies: walnut, grey oak

Flat Front Doors: pigmented lacquer, walnut, grey oak

Frame & Panel Doors: walnut, grey oak

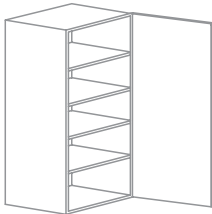

Tall height vertical unit

Tall Height Vertical Units
30", 36", 42" tall
14 7/8" Deep
Leaf Door(s)*
Open Unit with adjustable shelves
Concealed Hood Vent
*** Units wider than 24" have two doors**

PANTRY UNITS

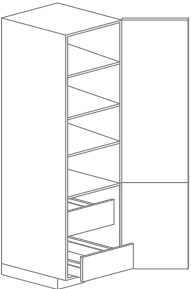

Pantry unit with drawers

Pantry Units with Leaf Door(s)
30" tall, adjustable shelves or 2 interior drawers
50" + 60" tall, adjustable shelves
68", 76", 80", 90" tall, with 2 interior drawers at bottom
and adjustable shelves above, 2 stacked doors
68", 76", 80", 90" tall with adjustable shelves + full height door
***Units wider than 27" have two doors**

Cabinet Bodies: plywood core, walnut, grey oak

Flat Front Doors: pigmented lacquer, walnut, grey oak

Frame & Panel Doors: walnut, grey oak

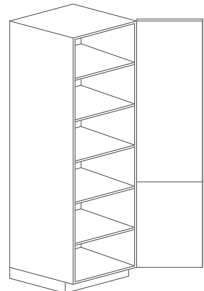

Pantry unit with adjustable shelves

COMPONENT

DESCRIPTION

AVAILABLE MATERIALS / FINISHES

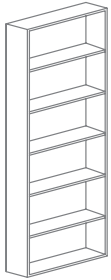

Open unit

Open Tall Units: 8", 12 7/8" deep
Open unit with fixed shelves : 50", 60", 68", 70"
80", 90" tall

Cabinet Bodies: veneer - walnut, grey oak

OVEN STACKS

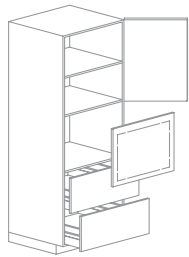

Oven stack

Oven Stacks
Single Oven unit available generic or fitted for a select number of recommended models

Double Oven (not shown)

Cabinet Bodies: veneer - walnut, grey oak

Flat Front Doors: pigmented lacquer, walnut

Frame & Panel Doors: walnut, grey oak

COMPONENT

DESCRIPTION

AVAILABLE MATERIALS / FINISHES

SHELVING



Floating shelf

Floating Shelf (includes hardware for installing)
Available in 5", 8", 12" depths

Floating Shelf: pigmented lacquer, veneer - walnut, grey

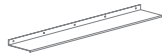

"Z" shelf

Floating "Z" Shelf
Available in 5", 8", 12" depths

"Z" Shelf: powdercoated steel. Fasteners provided. Holes to be drilled onsite.

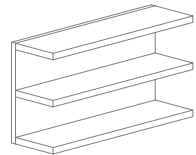

Shelf bank

Shelf Banks
Back panels available with 8", 12" deep shelves

Shelf Bank: veneer panel with pigmented lacquer shelves

PANELS

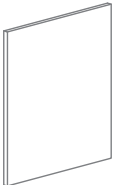

End panel

Cabinet Panels
Base Run End Panel
Tall Unit End Panel
Island or Peninsula Panel

Panels: pigmented lacquer, veneer - walnut, grey oak

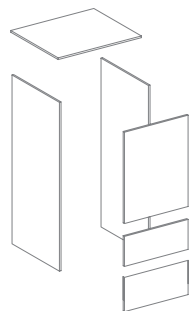

Refrigerator wrap

Dishwasher Panels
Front Panel for 24" European dishwasher
Front Panel for 24" US dishwasher
Front Panel for 18" Miele dishwasher

Refrigerator Panels and Kits
Universal Wrap Kit- top and side panels to be sized at installation
Overlay Front Panel Kit - Subzero 700 Series

Wall Panels
Backsplash Panel
Cleated Wall Panel
Aluminum Backsplash Panel

Custom Panels are available to your specific dimensions - max 46" x 94"

COMPONENT

DESCRIPTION

AVAILABLE MATERIALS / FINISHES

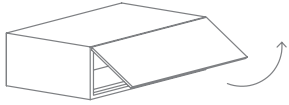

Above Refrigerator Unit

Above Refrigerator Unit - 10", 14", 22" Tall
Available Widths - 24", 27", 30", 32", 36", 42"
Depth 24 5/8" depth
Flip-up door

Flat Front Doors: pigmented lacquer, walnut, grey oak

Frame & Panel Doors: walnut, grey oak

Countertops



Pre-cut solid countertops with integrated backstop strip.
Sized to kitchen layout.
Includes installation kit.

1/2" LG solid surface: select colors

1/2" Paperstone: slate

3/4" Paperstone: slate

COMPONENT

DESCRIPTION

AVAILABLE MATERIALS / FINISHES

ISLAND "A"

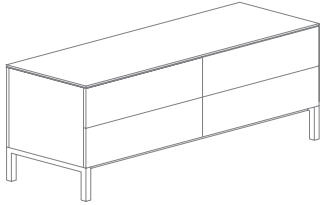

Fixed Elevated Island Unit

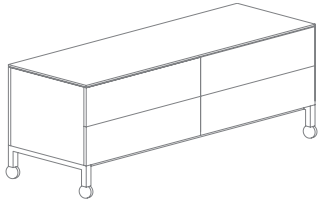

Mobile Elevated Island Unit

Mobile or fixed unit with steel base

Variety of drawer configurations available using standard range of materials for cabinets.

Steel base with option for wheels
Up to 3 storage units
Countertop

Height: 36"

Available in lengths up to 84"

Available widths: 24 5/8" and 29 1/2"

Walnut, grey oak

Base: Powdercoated steel

LG, Paperstone or wood surface

ISLAND EXTENSION

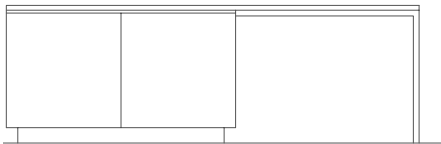

Powdercoated steel extension provides support for cantilevered countertop

Height: 36"

Available lengths up to 6'

Available widths: 24 5/8", 29 1/2" and 36"

Powdercoated steel

COMPONENT

DESCRIPTION

AVAILABLE MATERIALS / FINISHES

DRAWER INSERTS

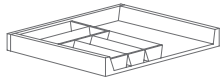

Utensil tray

Utensil Tray and Dividing System
Organizational accessories are designed to fit precisely within drawers. These accessories can be ordered individually based on your needs.

The drawer components are made of stainless steel with plastic fittings

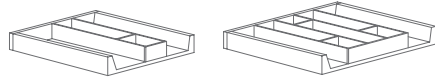

Dividing system

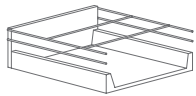

Rail unit organizer

Rail Unit Organizer
The rail unit can be adjusted to accommodate a range of storage requirements.

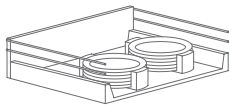
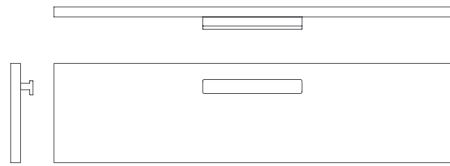

Plate organizer

Plate Organizers
Organizational accessories like these removable plate holders are designed to optimize storage. They are expandable so they can fit bowls to large dinner plates.

PULL OPTIONS

Viola Park Pulls are precision machined from solid aluminum. They have a clear anodized finish that hardens the aluminum, protecting them from scratching and wear, and maintaining the pull's luster.



STAPLE A

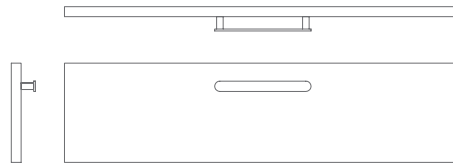

STAPLE B

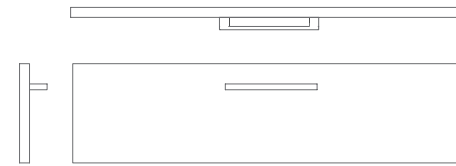

STAPLE E

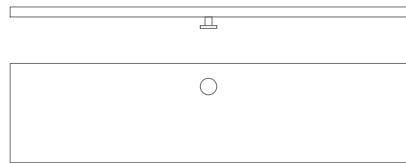

KNOB A

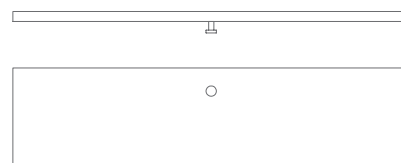

KNOB A sm